

# SPECIFICATION & TECHNICAL INFORMATION SHEET



PHP Item Number: PP10-R & Pipe Guide

## DESCRIPTION:

The **PP10 with Roller & Pipe Guide** is designed to support gas lines up to 3-1/2" OD and not exceeding 16" in height. The pipe guide prevents the pipe from slipping off of the support. The support is designed for installation without roof penetrations, flashings, or damage to the roofing material. The system can be used on virtually any roofing system from flat roofs to roofs sloped up to 2 in 12. The supports should be spaced according to the specifications. Seismic and High-Wind applications are available for the system.

## INSTALLATION PROCEDURE:

### New Pipe

1. Layout isolation pads according to the design and layout, (provided by contractor).
2. Layout PP10 supports per spacing specifications or PHP layout.
3. Run pipe between roller and pipe guide.
4. Adjust Roller height so weight of system is evenly distributed.

### Retro fit

1. Lift pipe, (enough to remove existing support).
2. Clean area where new support is to be placed.
3. Place ISO pad, (provided by contractor).
4. Put PP10 support on pad.
5. Remove nut from one side of the pipe guide and pivot guide 90 degrees.
5. Lower pipe on roller.
7. Pivot pipe guide back into place and reinstall nut.
8. Adjust roller height so weight of system is evenly distributed.

## STORAGE:

Store in the original, unopened containers, under cover, until needed for installation.

## LEED INFORMATION:

Frame/Steel

Post Consumer Recycled Content: 0%

Post Industrial Recycled Content: 25%

Manufacturing Location:

## BASE MATERIAL:

Post Consumer Recycled Content: 80%

Post Industrial Recycled Content: 20%

Manufacturing Location:

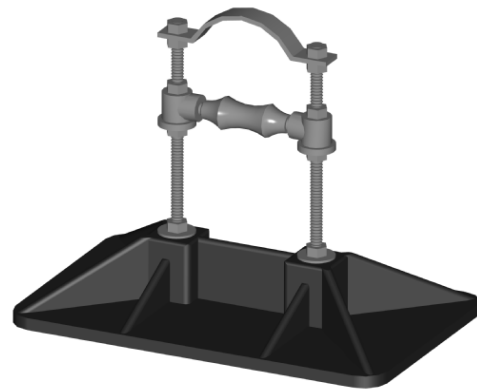

PP10-R & Pipe Guide

## PRODUCT DATA:

### Property:

#### Base:

Size:

Weight:

Base Material:

Base Color:

Base Density:

### Rod Type:

Diameter:

Length:

Finish:

### Carbon Steel Roller:

Roller Type:

Carbon Steel Finish:

### Pipe Guide:

Carbon Steel Finish:

### Hardware:

Nuts and Washers:

### Minimum Performance:

10" x 16" x 3"

5 1/2 lbs.

Injection molded high density/high impact polypropylene with UV-inhibitors and Antioxidants.

Black

55.8 lb/cu ft (894 kg/cu m)

1/2"

4" – 16"

Hot Dip Galvanized or Stainless Steel

3" Cast Iron Roller with Malleable Sockets

Hot Dip Galvanized per ASTM A 123

Hot Dip Galvanized

Hot Dip Galvanized or Stainless Steel

PHP Systems/Design  
5534 Harvey Wilson Drive  
Houston, TX 77020  
Tel: (800) 797-6585 or Local (713) 672-5088  
Fax: (713) 672-1170  
[www.phpsd.com](http://www.phpsd.com)  
[info@phpsd.com](mailto:info@phpsd.com)