

OPTIONAL ACCESSORIES FOR PS AND PSE CUSTOM SUPPORTS

Roller Hanger for use with Gas and other bare pipes

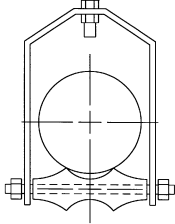

Band Hanger for use with HVAC and other insulated pipes

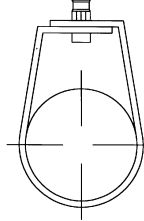

Clevis Hanger for use with HVAC and other insulated pipes

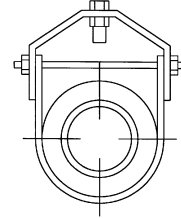

Accessory Bar for use with Conduit or Cable under 2½" in diameter

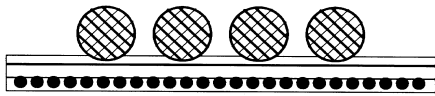

Pipe Guide for use with PP10 and SS8 units with roller assembly

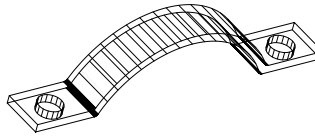

J-Clamp for 2" and smaller conduit line

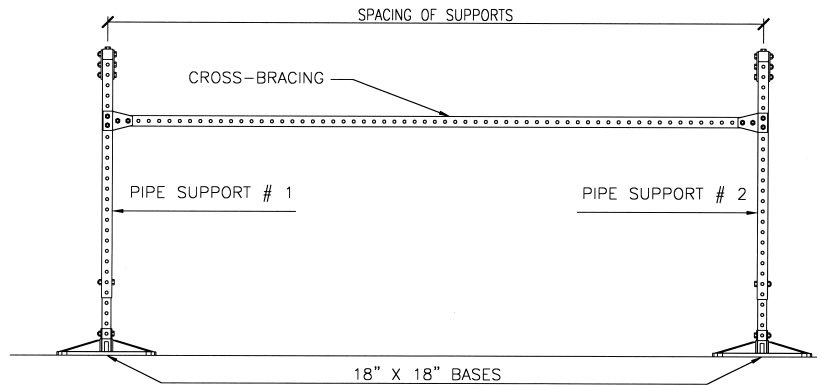

Straight Bracing for pipes 24" above the roof surface and higher.

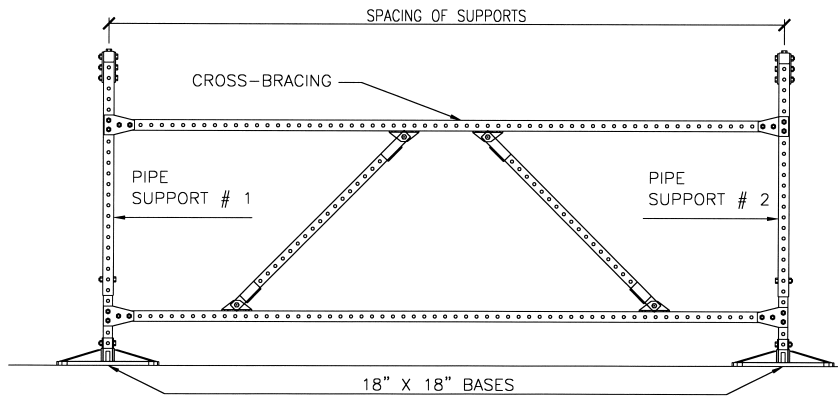

"K" bracing for pipes 24" above the roof surface and higher.